

## Product Specifications

Product	P10
Led type	SMD 3535
Pixel Pitch(mm)	10
Module Size (mm)	320×320
Screen Size (mm)	1280×960×145
Weight(Kg)	49
Brightness(Nit)	6,600
Max Power Consumption (W/m <sup>2</sup> )	651
Avg Power Consumption (W/m <sup>2</sup> )	195
Refresh Rate (Hz)	3,840
Gray Scale (Bit)	16
IP Rating (Front/Rear)	IP65
Service Ability	Front &Rear



# 01

Front & Rear  
service



**Front service**



**Rear service**



Support to remove the module and other parts from front & rear

## 02 Quick maintenance (module)

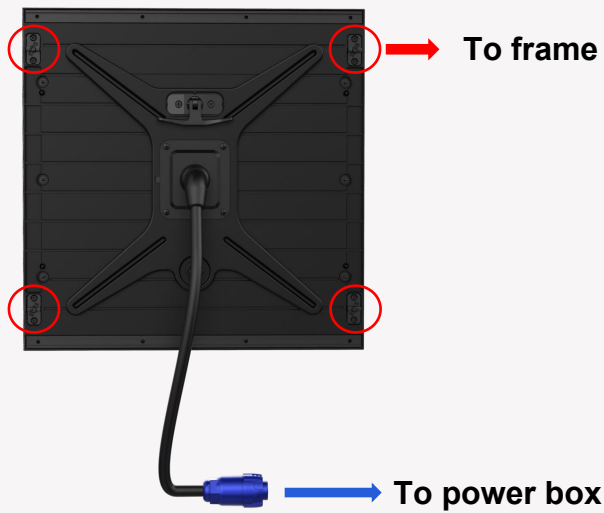

4 locks fix module to cabinet, aerial plug connect module with power box . One module can be replaced within just 10 seconds.

## 03 Quick maintenance (Power box)

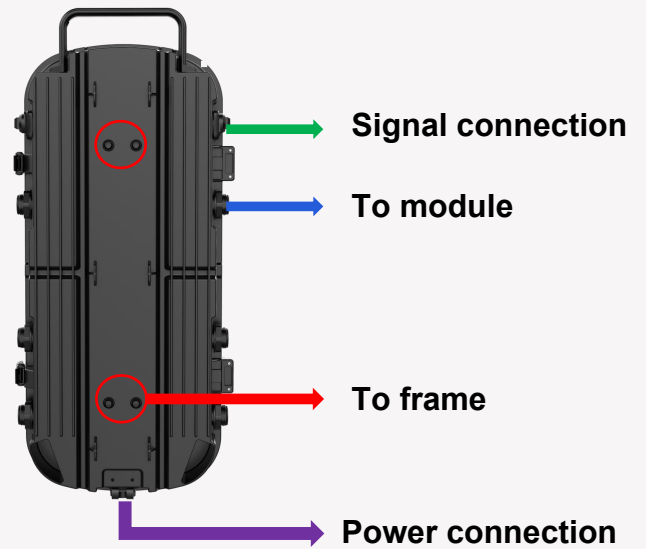

The power box is assembled on the frame on 2 hangers, and other connections are through Aerial plugs. It is available to make the replacement within 30 seconds, which is very convenient

## 04 Separate Design



Module heating separate from the power heating to prevent superimposed on heat ; better lifetime thereafter.

## 05 External Test



Test button on each cabinet, can be used for cabinet display testing, including color, scan line, gray scale testing

## 06 Monitoring information



LCD panel on each cabinet, showing status of both power connection and signal connection. Easy and fast to check if there is some issue.

## 07 Smart Module Technology



The calibration data is stored in the module, and the data can be read directly after changing the module

## 08 Energy Efficient

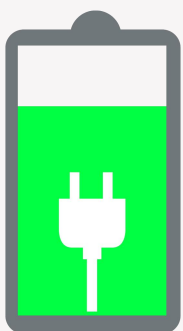

**10%**  
saving energy

Using low voltage DC power supply, saving energy consumption of products about 10%

## 08 Anti-UV

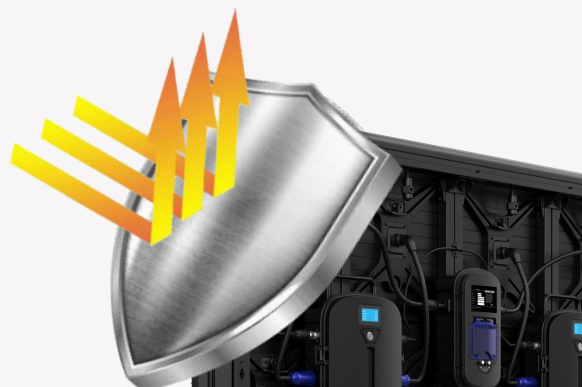

The structural components are mixed with UV resistant materials, which can work under sunlight for a long time without discoloration

## 10 Meet UEFA Requirements



Product design parameters and performance fully meet the UEFA standard requirements

## 11 Fully waterproof design



100% sealed module and 100% sealed power box, IP65 on both sides (Front&Rear)

## 12 Quick Installation

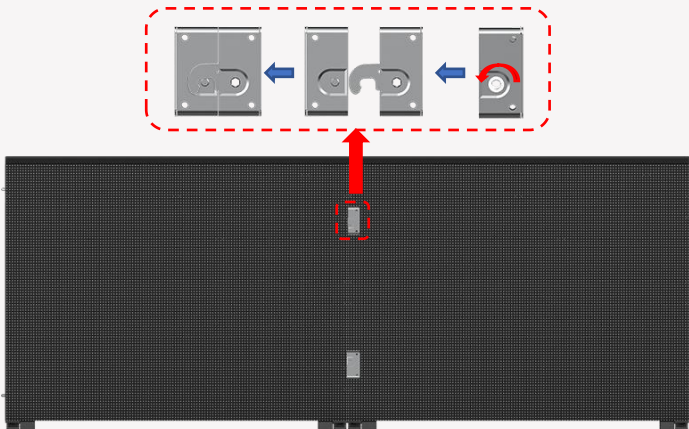

With side locks on both sides  
Fast connection to save time to finish installation

## 13 Independent Switch Box



Each box with circuit breaker; just power off the single cabinet for service when failure happens on it;

## 14 Soft Louver and Rubber Protection



Anti-collision and soft louvers design, protect athletes from crashing.

## 15 Rotating Base Design



The XRF series' support bottom shell with two designs; can remove the shelf from both sides and add the rotating base for different applications.

## 16 Rotatable support (With Rotating stents)

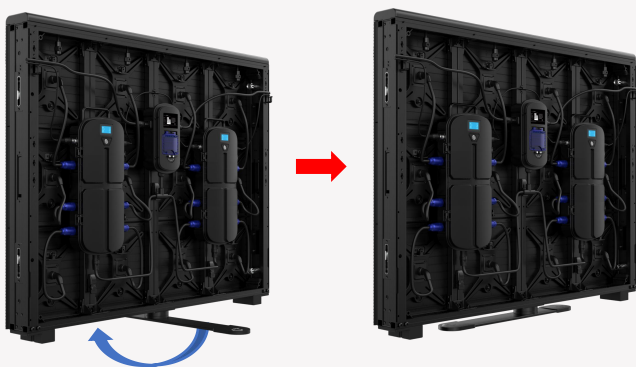

In case of emergency, the display can be rotated to open an escape route for the football players inside the stadium to evacuate

## 17 Adjustable Cabinet Angle (With Sloping stents)

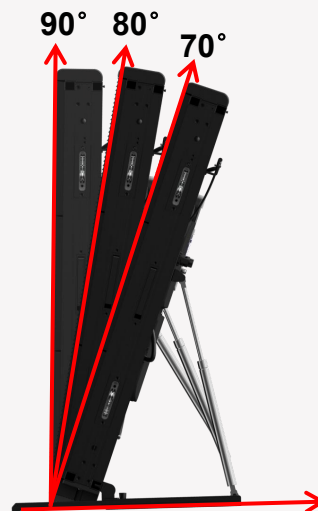

Removable bracket design, support 70°/80°/90° degree adjustable to ensure best viewing sweet spot for TV cameras request.

## 18 Dual power backup

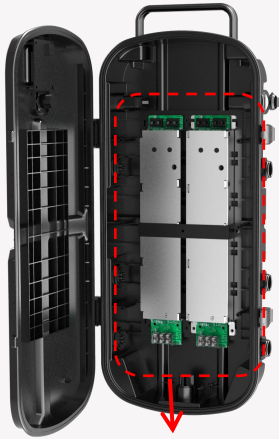

### 80A uniform current PSU

Support continuous power supply replacement under the case of failure, effectively ensure the stability of the field broadcast. Each one can be back up for the other one.

## 19 Fix Installation & Stadium



When remove the base structure and the anti-collision beam, SP series cabinet can be used for fix installation through upper locker and bottom lock.